

Baureihen KHT Kurvenrolle ohne Dichtring
 KHT ...PP Kurvenrolle mit Dichtring

für zylindrischen Mantel:
 Nachsetzzeichen „X“

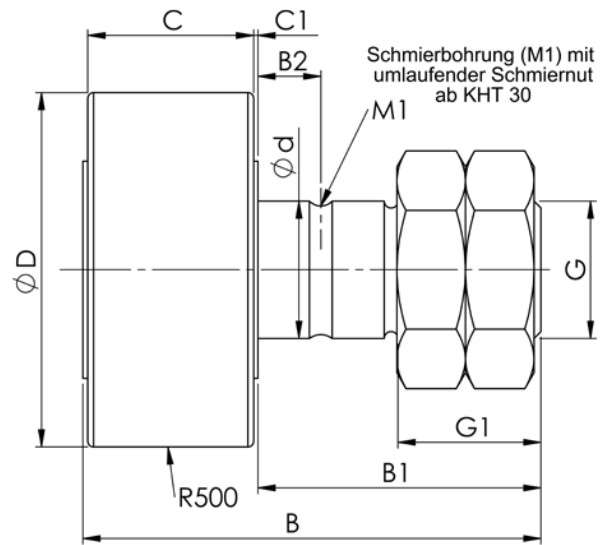

| D | Bezeichnung | | Abmessungen in mm | | | | | | | | |
|-----|---------------|--------------|-------------------|----|----|------|-------|------|----|----------|----|
| | ohne Dichtung | mit Dichtung | D | d | C | C1 | B | B1 | B2 | G | G1 |
| 14 | KHT 14 | KHT 14 PP | 14 | 6 | 9 | 0,25 | 26,0 | 16,0 | / | M6 | 8 |
| 16 | KHT 16 | KHT 16 PP | 16 | 6 | 11 | 0,6 | 28,2 | 16,0 | / | M6 | 8 |
| 19 | KHT 19 | KHT 19 PP | 19 | 8 | 11 | 0,6 | 32,2 | 20,0 | / | M8 | 10 |
| 22 | KHT 22 | KHT 22 PP | 22 | 10 | 12 | 0,6 | 36,2 | 23,0 | / | M10x1 | 12 |
| 24 | KHT 24 | KHT 24 PP | 24 | 10 | 12 | 0,6 | 36,7 | 23,5 | / | M10x1,25 | 12 |
| 26 | KHT 26 | KHT 26 PP | 26 | 10 | 12 | 0,6 | 36,2 | 23,0 | / | M10x1 | 12 |
| 28 | KHT 28 | KHT 28 PP | 28 | 10 | 12 | 0,6 | 36,0 | 22,9 | / | M10x1,25 | 12 |
| 30 | KHT 30 | KHT 30 PP | 30 | 12 | 14 | 0,6 | 40,2 | 25,0 | 6 | M12x1,5 | 13 |
| 32 | KHT 32 | KHT 32 PP | 32 | 12 | 14 | 0,6 | 40,2 | 25,0 | 6 | M12x1,5 | 13 |
| 35 | KHT 35 | KHT 35 PP | 35 | 16 | 18 | 0,8 | 52,0 | 32,5 | 8 | M16x1,5 | 17 |
| 40 | KHT 40 | KHT 40 PP | 40 | 18 | 20 | 0,8 | 58,0 | 36,5 | 8 | M18x1,5 | 19 |
| 47 | KHT 47 | KHT 47 PP | 47 | 20 | 24 | 0,8 | 66,0 | 40,5 | 9 | M20x1,5 | 21 |
| 52 | KHT 52 | KHT 52 PP | 52 | 20 | 24 | 0,8 | 66,0 | 40,5 | 9 | M20x1,5 | 21 |
| 62 | KHT 62 | KHT 62 PP | 62 | 24 | 29 | 0,8 | 80,0 | 49,5 | 11 | M24x1,5 | 25 |
| 72 | KHT 72 | KHT 72 PP | 72 | 24 | 29 | 0,8 | 80,0 | 49,5 | 11 | M24x1,5 | 25 |
| 80 | KHT 80 | KHT 80 PP | 80 | 30 | 35 | 1,0 | 100,0 | 63,0 | 15 | M30x1,5 | 32 |
| 90 | KHT 90 | KHT 90 PP | 90 | 30 | 35 | 1,0 | 100,0 | 63,0 | 15 | M30x1,5 | 32 |
| 100 | KHT 100 | KHT 100 PP | 100 | 36 | 40 | 1,1 | 117,5 | 75,3 | 20 | M36x3 | 38 |
| 110 | KHT 110 | KHT 110 PP | 110 | 36 | 40 | 1,1 | 117,5 | 75,3 | 20 | M36x3 | 38 |
| 120 | KHT 120 | KHT 120 PP | 120 | 42 | 46 | 1,1 | 136,5 | 88,3 | 24 | M42x3 | 44 |
| 130 | KHT 130 | KHT 130 PP | 130 | 42 | 46 | 1,1 | 136,5 | 88,3 | 24 | M42x3 | 44 |

Rostarme bzw. rostgeschützte Baureihen auf Anfrage lieferbar.

Kurvenrollen ohne Exzenter



Kurvenrollen mit Exzenter
siehe Seiten 60/61.

| M1 | Innen- skt. SW | Mutteranzieh- moment Nm | Gewicht ≈g | Tragzahlen in kN | | | | Grenz- drehzahl min ⁻¹ |
|----|----------------------|-------------------------------|---------------|---------------------------|----------|------------------------|----------|---|
| | | | | als Kurvenrolle C dyn. | Co stat. | Grenzlasten Fr zul. | Fro zul. | |
| / | / | 2 | 21 | 4,85 | 6,5 | 1,18 | 2,2 | 3800 |
| / | / | 5 | 34 | 5,50 | 7,9 | 2,83 | 5,2 | 3100 |
| / | / | 16 | 55 | 6,30 | 9,1 | 4,90 | 8,1 | 2600 |
| / | / | 16 | 71 | 7,30 | 11,3 | 5,20 | 9,6 | 2600 |
| 3 | / | 22 | 107 | 9,50 | 14,6 | 7,70 | 14,3 | 2100 |
| 3 | / | 22 | 116 | 10,00 | 15,8 | 7,70 | 14,3 | 2100 |
| 3 | 8 | 55 | 205 | 15,00 | 16,8 | 8,60 | 16,8 | 6500 |
| 3 | 8 | 75 | 285 | 18,40 | 22,6 | 13,10 | 22,6 | 5500 |
| 4 | 10 | 100 | 447 | 28,00 | 35,0 | 16,40 | 33,0 | 4200 |
| 4 | 10 | 100 | 520 | 29,00 | 37,5 | 17,30 | 34,5 | 3400 |
| 4 | 14 | 180 | 905 | 40,00 | 50,0 | 23,50 | 46,5 | 2600 |
| 4 | 14 | 180 | 1130 | 44,50 | 60,0 | 32,00 | 60,0 | 2100 |
| 4 | 14 | 370 | 1818 | 69,00 | 98,0 | 47,50 | 96,0 | 1800 |
| 4 | 14 | 370 | 2180 | 79,00 | 117,0 | 77,00 | 117,0 | 1800 |
| 4 | 17 | 740 | 3186 | 85,80 | 133,0 | 76,00 | 142,0 | 2200 |
| 4 | 19 | 740 | 3730 | 95,00 | 150,0 | 76,00 | 142,0 | 2100 |
| 4 | 19 | 1200 | 5200 | 105,00 | 172,0 | 120,00 | 200,0 | 2000 |
| 4 | 19 | 1200 | 6400 | 119,00 | 196,0 | 121,00 | 223,0 | 2000 |